

IQ Flex Calibration Process.

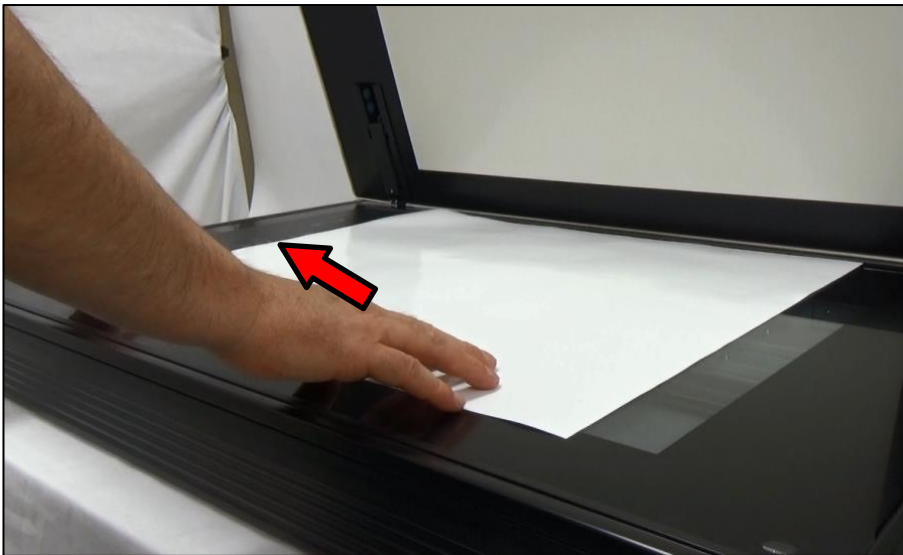

1. Before calibrating, make sure the Glass Plate is clean.



2. Correctly insert the calibration target onto the scanner with the targets arrow pointing towards the left.

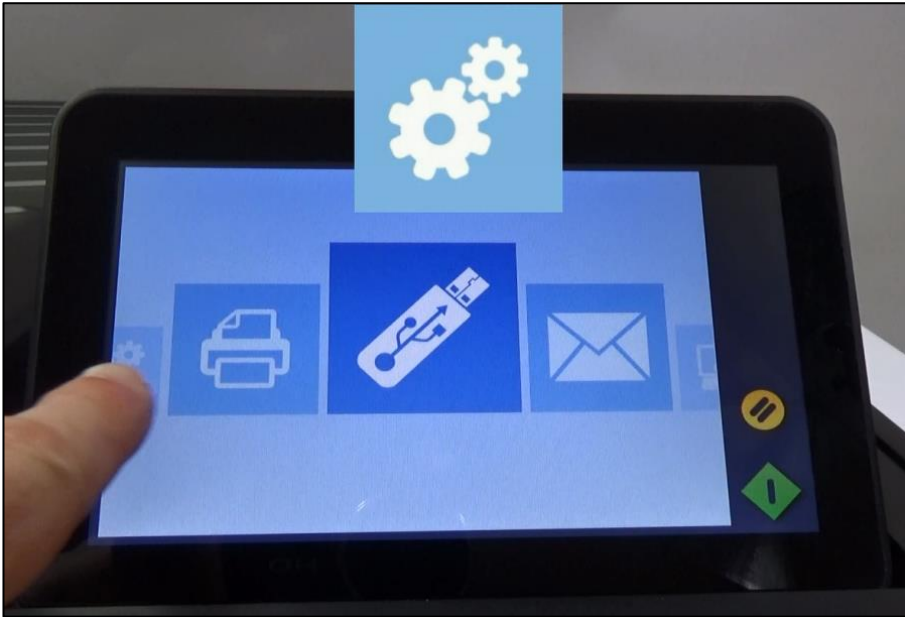

3. On the scanner touchscreen, use your finger to move the icon to the 'Setup' icon.



4. Using your finger, move the icon to the 'Setup' icon, and then choose 'Scanner'.

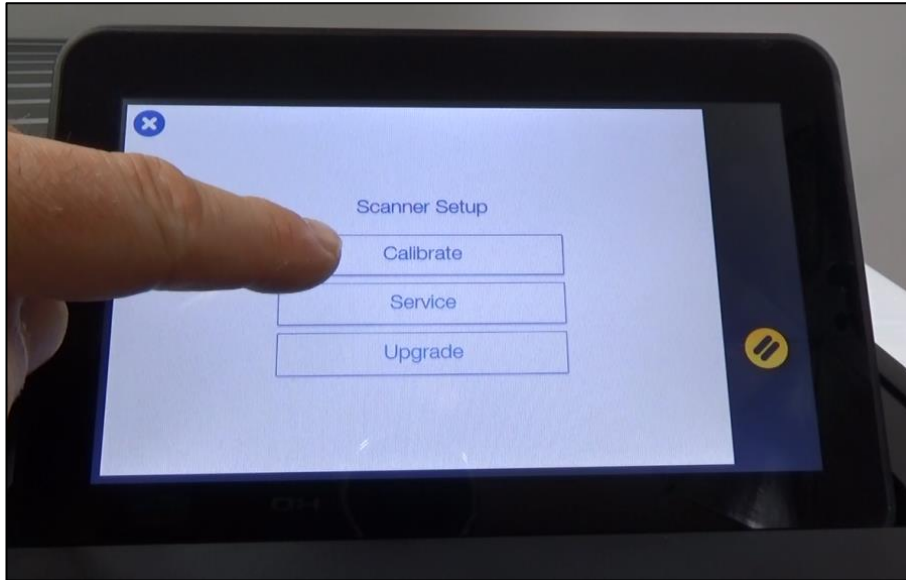

5. Click 'Calibration'.

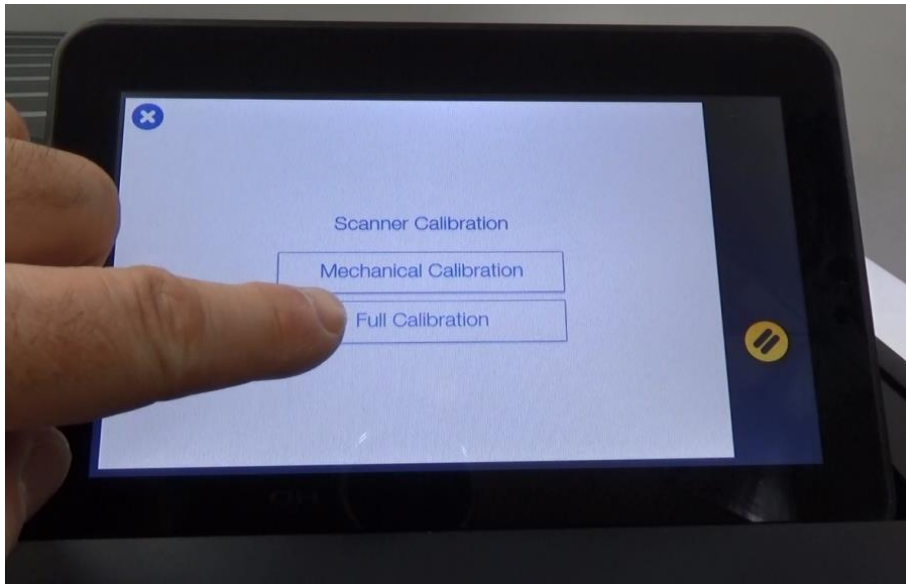

6. Click 'Full Calibration'. The Calibration will take about 27 minutes. Remove the target when completed.